



Edgewood University Cultural Resource Policies, Procedures, and Practices

1000 Edgewood College Drive, Madison, WI 53711

2019

Land Recognition Statement:

"We recognize this sacred land on which our University exists. Our Dominican heritage, educational mission, and core values call us to be stewards of this land and the Native mounds located throughout our campus. We respectfully acknowledge our local First Nation, the Ho-Chunk, and the additional 11 Indigenous Nations of Wisconsin that have shaped our state's history and our local community."

1. Purpose

This document details the policies, procedures, and practices for caring for and maintaining each of the Indian effigy, conical, and linear mounds on the Edgewood University campus grounds, while valuing the cultural and historical significance of these mounds. All mound care and oversight will be performed in accordance with the Wisconsin's Burial Sites Preservation Law (Wis. Stat. § 157.70) and guidance from the Wisconsin Department of Natural Resources' Burial, Earthworks, and Mounds Preservation Policy and Plan (DNR Plan).

2. Resources

The Wisconsin Historical Society Division of Historic Preservation-Public History Compliance Archaeologist and the Ho-Chunk Nation Tribal Historic Preservation Officer shall be the primary consultants to Edgewood University regarding the Edgewood University Cultural Resources Policies, Procedures, and Practices.

3. Responsibility for Application of Cultural Resource Policies, Procedures, and Practices

The Landscape and Grounds Department will perform or oversee any and all mound care and will coordinate with Resources identified in this document as well as other University resources, e.g. Executive Director of Diversity and Inclusion.

4. Policies

The following policies are applicable to every mound on the University grounds. Individual mound care is detailed under section 7, Care Procedures and Practices. All mounds are numbered under section 5 and mapped under section 6.

- A. The Edgewood University Mound Group is designated landmark Site #104. The City of Madison Landmarks Commission must approve all building projects or other land disturbances occurring within fifty feet of the mounds' boundaries as indicated in the Landmarks and Landmark Sites Nomination Form for Site 104 prior to obtaining building permits.
- B. Any alteration or care outside of the procedures and practices outlined in this document, including construction and excavation that may cause or permit the disturbance of cataloged land, must be done in consultation with the Ho-Chunk Nation Tribal Historic Preservation Officer and approved by the Wisconsin State Historical Society and Landmarks Commission.
- C. All current work on or near the mounds will be in compliance with Wis. Stat. § 157.70.
- D. The DNR Plan will provide guidance, not authorization, on the care of the mounds.
- E. Invasive plant removal will take place seasonally or as needed on each of the mounds.
 - i. Woody invasive plants will be cut at ground level. Stumps will be treated with an herbicide to prevent resprouting.
 - ii. Stumps may not be removed.
 - iii. Herbaceous invasive plants will be sprayed with herbicide or mowed. Plants may not be pulled, dug or otherwise removed by the roots.

5. Mound Assigned Numbers, Location Descriptions, and Names

Mound 1 – SE corner of University lot – “Panther Mound”

Mounds 2-4 – NW of Siena Apartments, E of Campus School – “Siena Heights Series”
(Cared for as one collective mound)

Mound 5 – SE of East Regina, SW of Campus School – “East Regina Mound”

Mound 6 – N of Mazzuchelli Hall, S of Regina Hall – “Mazz Conical Mound”

Mounds 7-9 – SE of Stevie Hall, NW of Mazzuchelli Hall – “Park and Pleasure Drive Eastern Series”
(Located on property easement to the City of Madison)

Mounds 10-12 – SW of Stevie Hall – “Park and Pleasure Drive Western Series”
(Partially located on property easement to the City of Madison)

Mounds 13-14 – S of Library, W of Stevie Hall – “Library Mounds”

Mound 15 – SW of DeRicci Hall, NW of Library – “Bird Mound”

6. Campus Map

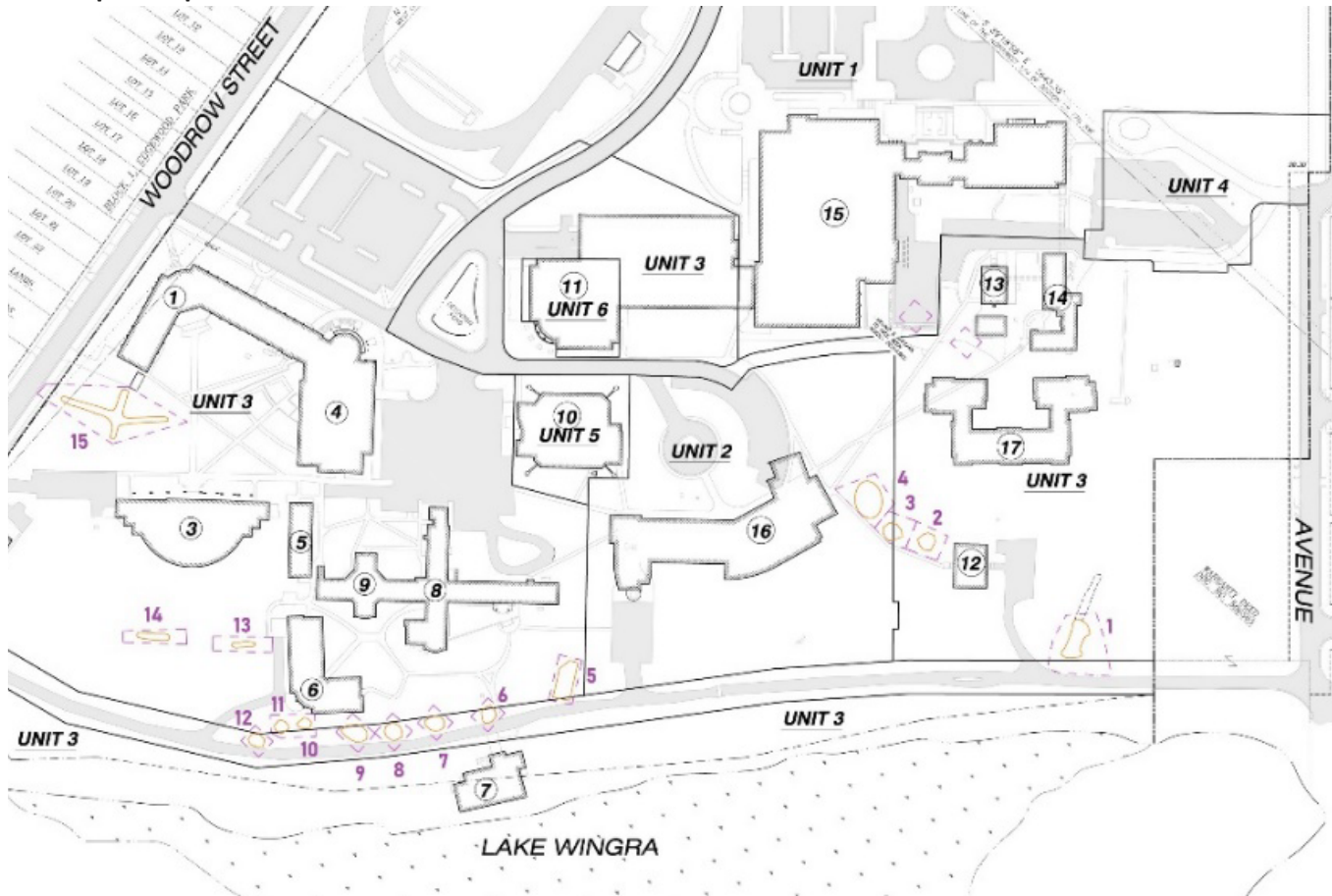

Buildings

1 DeRicci Hall	6 Marie Stephen Reges Hall	10 Todd Wehr Edgedome	14 Marshall Hall
3 Oscar Rennebohm Library	7 Mazzuchelli Biology Station	11 Sonderegger Science Center	15 Edgewood High School
4 Predolin Humanities Center	8 Regina Hall	12 Siena Heights Apartments	16 Edgewood Campus School
5 Weber Hall	9 St. Joseph Chapel	13 Facilities Headquarters	17 Dominican Hall

7. Care Procedures and Practices

Care Responsibilities	Mound Assigned Numbers			
	1, 5, 6, 10-12, 13-14	7-9	2-4	15
Mound is located in a natural forest or prairie setting.	✓	✓		✓
Work will be completed by or with authorization from the City of Madison, due to location within City of Madison Easement area.		✓		
Damaged, hazardous, or invasive trees will be cleared as necessary. If appropriate, work should occur when ground is frozen.	✓			
Stump grinding will not occur. Stumps may be cut flush to ground and treated with herbicide to prevent resprouting.	✓		✓	✓
Leaf and forest debris will not be removed.	✓	✓		
Garbage and litter waste will be removed.	✓	✓	✓	✓
Mound is presently covered with turf grass in maintained landscape area.			✓	
Trees, shrubs, or plants will not be installed in or around these mounds.	✓	✓	✓	✓
Over-seeding of grass may occur in order to prevent erosion. No straw mats or staples will be used.			✓	
Soil will not be added or removed.	✓	✓	✓	✓
Grass will be mowed monthly or as needed with a push mower at a blade setting sufficient to ensure damage does not occur.			✓	
Leaves and branches will be removed monthly or as needed.			✓	
Area may receive prescribed burn treatment, with permitting by City of Madison.				✓
Fence may be maintained, repaired, or updated in order to deter pedestrian traffic and to protect mound.				✓